

KLEVV NVMe M.2 SSD INSTALLATION GUIDE

CONTENTS

OVERVIEW

SYSTEM REQUIREMENTS

BEFORE YOU BEGIN

SSD HANDLING PRECAUTIONS

DESKTOP INSTALLATION

- Install Migration Tool
- Migrate Your Data
- Swap or Install Your Drives
- Change the Boot Order of the Drives from BIOS

LAPTOP INSTALLATION

- Install Migration Tool
- Migrate Your Data
- Swap Your Drives

WARRANTY AND TECHNICAL SUPPORT

Overview

This guide explains how to install a KLEVV M.2 Solid-State Drive (KLEVV NVMe M.2 SSD) in a desktop or notebook computer.

System Requirements

System Requirements for KLEVV CRAS C700 NVMe SSD installation

1. An available M.2 slot that supports NVMe SSD on your motherboard or PC. (You may need to consult your owner's manual or contact your motherboard or PC manufacturer for detailed information)

* Please make sure that your motherboard or PC has enough physical space to support KLEVV CRAS C700 series NVMe SSD.

<i>Model</i>	<i>Dimension</i>	<i>Remark</i>
CRAS C700 M.2 NVMe SSD	80 (L) x 22 (W) x 2.8 (H) mm	Double-Sided
CRAS C700 RGB M.2 NVMe SSD	80 (L) x 24 (W) x 22 (H) mm	

2. System BIOS is capable of supporting NVMe SSD. (You may need to consult your owner's manual or contact your motherboard or PC manufacturer for detailed information)
3. Windows 8.1 and Windows 10 with native support for NVMe SSDs. Windows 7 does not natively support PCIe NVMe SSDs. To use or install Windows 7 on a NVMe SSD, please consult with Microsoft for more information.

Before You Begin

Confirm you have the following hardware for installation

* These tools are not included in the package. You may need to prepare by yourself.

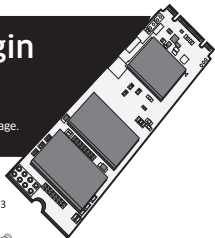

1

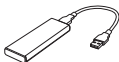

2



3



Hardware Item

- 1 USB to NVMe M.2 2280 adaptor and USB cable
- 2 Screwdriver
- 3 Screws

Required For

- Laptop/desktop computers to migrate your data
- Laptop/desktop computers
- Laptop/desktop computers

SSD Handling Precautions—

Observe the following before beginning the installation:

- Handle the SSD with care. Do not touch the gold connectors.
- To minimize static electricity, touch the computer case before handling the SSD.
- Do not remove the encasement, labels or disassemble the SSD ; these actions void the SSD warranty.

Desktop Installation

Install Migration Tool - Acronis True Image 2018___

* Please skip this step if you don't need to migrate your data.

1. If your KLEVV NVMe M.2 SSD provides Migration Tool (Acronis True Image 2018), please download the software and its user's manual from the following KLEVV website. (www.essencore.com or www.klevv.com)
* You may also use your own software for the data migration.
2. Follow the instructions to install the Migration Tool to your desktop.

Migrate Your Data___

1. Please make sure that you have installed the Migration Tool
2. Install the KLEVV NVMe M.2 SSD to the USB to NVMe M.2 2280 adaptor. (You may need to consult the user manual of your USB to NVMe M.2 2280 adaptor)

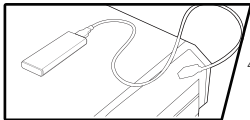

3. Connect the KLEVV NVMe M.2 SSD to your desktop using the USB to NVMe M.2 2280 adaptor.
 4. Run the Migration Tool, and follow the instructions to migrate your operating system and data to the new KLEVV NVMe M.2 SSD.
5. Safely remove your KLEVV NVMe M.2 SSD from USB when done.
 6. Disconnect your KLEVV NVMe M.2 SSD from the USB to NVMe M.2 2280 adaptor.

Swap or Install Your Drives ___

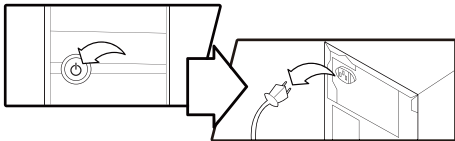

1. Power off your desktop and disconnect the power cord.

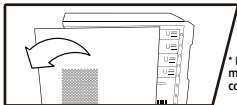

2. Open the cover of your computer.

*** If needed please refer to the service manual for your desktop to open the cover safely.**

3. Locate your computer's NVMe M.2 socket on the motherboard (You may need to consult your owner's manual for the exact location)

4. Remove the existing M.2 SSD from the M.2 socket (if applicable). Refer to your owner's manual for how to safely remove the existing M.2 drive.

5. Align the notches on the KLEVV NVMe M.2 SSD with the ridges in the M.2 socket, then insert as shown.

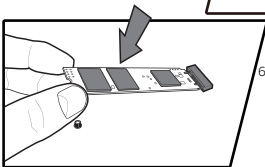
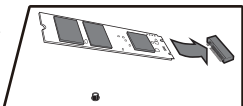

6. Hold KLEVV NVMe M.2 SSD along the side edges and lower it until it sits on top of the support assembly.

7. Insert screw into the support assembly and securely fasten the KLEVV NVMe M.2 SSD in.

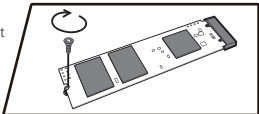

8. Reattach the covers to your desktop.

Change the Boot Order of the Drives from BIOS

1. Power on your computer. (You may also see a message prompting you to update your system's configuration settings. Refer to your owner's manual for instructions.)
2. While the computer is booting, press a special key such as ESC, F1, or DELETE to enter the BIOS menu. Check your computer manufacturer's documentation for the correct key(s).
3. Go to the Boot or Startup screen and change the boot order so that the KLEVV NVMe M.2 SSD appears before your old storage device.
4. Save the settings and exit the BIOS setup menu.
5. Restart the computer.
6. Now your computer boots to your KLEVV NVMe M.2 SSD.

Laptop Installation

Install Migration Tool - Acronis True Image 2018 _____

* Please skip this step if you don't need to migrate your data.

1. If your KLEVV NVMe M.2 SSD provides Migration Tool (Acronis True Image 2018), Please download the software and its user's manual from the following KLEVV website. (www.essencore.com or www.klevv.com)
* **You may also use your own software for the data migration.**
2. Follow the instructions to install the Migration Tool to your laptop.

Migrate Your Data _____

1. Please make sure that you have installed the Migration Tool.
2. Install the KLEVV NVMe M.2 SSD to the USB to NVMe M.2 2280 adaptor. (You may need to consult the user manual of your USB to NVMe M.2 2280 adaptor)
3. Connect the KLEVV NVMe M.2 SSD to your laptop using the USB to NVMe M.2 2280 adaptor.
4. Run the Migration Tool, and follow the instructions to migrate your operating system and data to the new KLEVV NVMe M.2 SSD.
5. Safely remove your KLEVV NVMe M.2 SSD from USB when done.
6. Disconnect your KLEVV NVMe M.2 SSD from the USB to NVMe M.2 2280 adaptor.

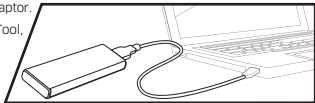

Swap Your Drives

1. Power off your laptop. Disconnect power cord and remove the battery.

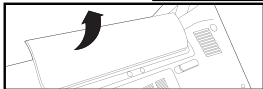
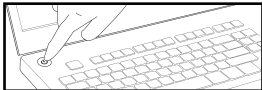

2. Remove the existing M.2 SSD from the M.2 socket (if applicable). Refer to your owner's manual for how to safely remove the existing M.2 drive.

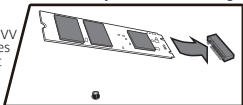

3. Align the notches on the KLEVV NVMe M.2 SSD with the ridges in the M.2 socket, then insert as shown.

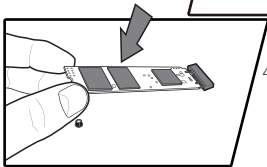

4. Hold KLEVV NVMe M.2 SSD along the side edges and lower it until it sits on top of the support assembly.

5. Insert screw into the support assembly and securely fasten the KLEVV NVMe M.2 SSD in.

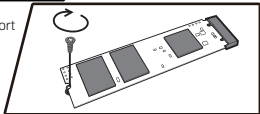

6. Replace the cover and power on the computer

Warranty and Technical Support

For more information about warranty, go to KLEVV website.
To apply for an RMA (Return Material Authorization), please contact
technical support at **support@essencore.com**